

**NITY ZRYWALNE Z POWIĘKSZONYM KOŁNIERZEM  
ALUMINIOWO-STALOWE POLEROWANE**

nit aluminiowy, trzpień stalowy



**ALUMINUM-STEEL LARGE FLANGE HEAD BLIND RIVETS**

alu body, steel mandrel

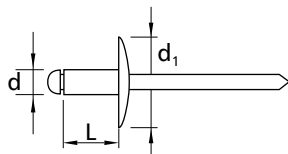
**BLINDNIETEN GROSSER FLACHRUNDKOPF, ALU/STAHL**

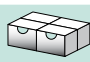

TYPE: NZASP

d × L × d <sub>1</sub> (mm)	index	EAN		 G (mm)		
4,0 × 18 × 15	NZASP401815	5902619616946	4,1	10,0 -14,5	250	2000
4,8 × 10 × 14	NZASP481014	5902619612504	4,9	4,0-6,0	250	2000
4,8 × 10 × 16	NZASP481016	5902619612511	4,9	4,0-6,0	250	2000
4,8 × 12 × 14	NZASP481214	5902619615239	4,9	6,0-8,0	250	2000
4,8 × 12 × 16	NZASP481216	5902619615246	4,9	6,0-8,0	250	2000
4,8 × 14 × 14	NZASP481414	5902619612528	4,9	8,0-10,0	250	2000
4,8 × 14 × 16	NZASP481416	5902619615284	4,9	8,0-10,0	250	2000
4,8 × 16 × 14	NZASP481614	5902619612535	4,9	8,0-12,0	250	2000
4,8 × 16 × 16	NZASP481616	5902619612542	4,9	8,0-12,0	250	2000
4,8 × 18 × 14	NZASP481814	5902619615253	4,9	10,0-14,0	250	2000
4,8 × 18 × 16	NZASP481816	5902619612559	4,9	10,0-14,0	250	2000
4,8 × 20 × 14	NZASP482014	5902619615260	4,9	12,0-16,0	250	2000
4,8 × 20 × 16	NZASP482016	5902619615277	4,9	12,0-16,0	250	2000



Zamawiając nity w kolorze RAL, dodaj numer koloru do indeksu  
np. NZASP481014-RAL. Oferta kolorów standardowych dostępna na str. 6.

To order painted blind rivets in colour RAL please add colour number  
to index e.g. N NZASP481014-RAL. Standard RAL colours offer available on page 6.

Bei Bestellung von lackierten Blindnieten geben Sie bitte das Farbnummer zu der Indexnummer  
z.B. NZASP481014-RAL, an. Die Angebotsstandardfarben auf Seite 6.



## NITY ZRYWALNE Z POWIĘKSZONYM KOŁNIERZEM

### ALUMINIOWO-NIERDZEWNE

nit aluminiowy, trzpień nierdzewny



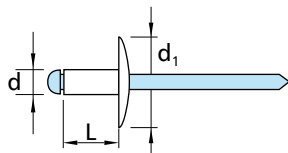

### ALUMINUM-STAINLESS STEEL LARGE FLANGE HEAD BLIND RIVETS

alu body, stainless steel mandrel

### BLINDNIETEN GROSSER FLACHRUNDKOPF, ALU/EDELSTAHL



#### TYPE: NZANP

d × L × d <sub>1</sub> (mm)	index	EAN		 G (mm)		
4,0 × 18 × 15	NZANP401815	5902619600488	4,1	10,0-14,5	250	2000
4,0 × 20 × 15	NZANP402015	5902619600495	4,1	12,0-16,0	250	2000
4,8 × 12 × 14	NZANP481214	5902619615604	4,9	6,0-8,0	250	2000
4,8 × 12 × 16	NZANP481216	5902619615611	4,9	6,0-8,0	250	2000
4,8 × 16 × 14	NZANP481614	5902619612566	4,9	8,0-12,0	250	2000
4,8 × 16 × 16	NZANP481616	5902619612573	4,9	8,0-12,0	250	2000
4,8 × 18 × 14	NZANP481814	5902619612580	4,9	10,0-14,0	250	2000
4,8 × 18 × 16	NZANP481816	5902619612597	4,9	10,0-14,0	250	2000
4,8 × 20 × 14	NZANP482014	5902619615628	4,9	12,0-16,0	250	2000
4,8 × 20 × 16	NZANP482016	5902619615635	4,9	12,0-16,0	250	2000

## NITY ZRYWALNE Z POWIĘKSZONYM KOŁNIERZEM NIERDZEWNE

nit nierdzewny, trzpień nierdzewny

### STAINLESS STEEL LARGE FLANGE HEAD BLIND RIVETS

stainless steel body, stainless steel mandrel



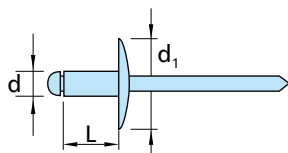

### BLINDNIETEN GROSSER FLACHRUNDKOPF, EDELSTAHL/EDELSTAHL



INOX



#### TYPE: NZNNP

d × L × d <sub>1</sub> (mm)	index	EAN		 G (mm)		
4,8 × 12 × 14	NZNNP481214	5902619615468	4,9	6,0-8,0	250	2000
4,8 × 12 × 16	NZNNP481216	5902619615475	4,9	6,0-8,0	250	2000
4,8 × 16 × 14	NZNNP481614	5902619600914	4,9	8,0 -10,0	250	2000
4,8 × 16 × 16	NZNNP481616	5902619600921	4,9	8,0 -10,0	250	2000
4,8 × 18 × 14	NZNNP481814	5902619615482	4,9	10,0-12,0	250	2000
4,8 × 18 × 16	NZNNP481816	5902619607937	4,9	10,0-12,0	250	2000
4,8 × 20 × 16	NZNNP482016	5902619607982	4,9	12,0-16,0	250	2000

## NITY ZRYWALNE ALUMINIOWO-STALOWE POLEROWANE

nit aluminiowy, trzpień stalowy



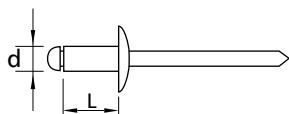

### ALUMINUM-STEEL BLIND RIVETS

alu body, steel mandrel

#### BLINDNIETEN FLACHRUNDKOPF, ALU/STAHL



TYPE: NZAS

d × L (mm)	index	EAN		 G (mm)		
3,0 × 6	NZAS3006	5902619601553	3,1	1,0-3,5	1000	4000
3,0 × 8	NZAS3008	5902619601560	3,1	3,5-5,0	1000	4000
3,0 × 10	NZAS3010	5902619601577	3,1	5,0-7,0	1000	4000
3,2 × 6	NZAS3206	5902619601584	3,3	1,0-3,5	1000	4000
3,2 × 8	NZAS3208	5902619601591	3,3	3,5-5,0	1000	4000
3,2 × 10	NZAS3210	5902619601607	3,3	5,0-7,0	1000	4000
3,2 × 12	NZAS3212	5902619601652	3,3	7,0-9,0	1000	4000
4,0 × 6	NZAS4006	5902619601614	4,1	1,0-3,0	1000	4000
4,0 × 8	NZAS4008	5902619601621	4,1	3,0-5,0	1000	4000
4,0 × 10	NZAS4010	5902619601638	4,1	4,0-6,5	1000	4000
4,0 × 12	NZAS4012	5902619601645	4,1	6,0-8,5	1000	4000
4,0 × 16	NZAS4016	5902619601874	4,1	8,0-12,5	500	4000
4,0 × 18	NZAS4018	5902619601737	4,1	10,0-14,5	500	4000
4,0 × 19	NZAS4019	5902619601669	4,1	13,0-15,0	500	4000
4,8 × 6	NZAS4806	5902619601676	4,9	1,0-2,5	500	4000
4,8 × 8	NZAS4808	5902619601683	4,9	2,5-4,0	500	4000
4,8 × 10	NZAS4810	5902619601690	4,9	4,0-6,5	500	4000
4,8 × 12	NZAS4812	5902619601706	4,9	6,0-8,0	500	4000
4,8 × 14	NZAS4814	5902619601713	4,9	8,0-10,0	500	4000
4,8 × 16	NZAS4816	5902619601720	4,9	8,0-12,0	500	4000
4,8 × 18	NZAS4818	5902619601751	4,9	10,0-14,0	500	4000
4,8 × 20	NZAS4820	5902619601881	4,9	12,0-16,0	500	4000
4,8 × 25	NZAS4825	5902619601898	4,9	16,0-21,0	250	2000

## NITY ZRYWALNE ALUMINIOWO-NIERDZEWNE

nit aluminiowy, trzpień nierdzewny



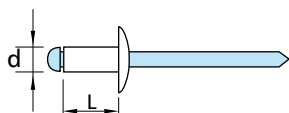

### ALUMINUM-STAINLESS STEEL BLIND RIVETS

alu body, stainless steel mandrel

#### BLINDNIETEN FLACHRUNDKOPF, ALU/EDELSTAHL



TYPE: NZAN

d × L (mm)	index	EAN		 G (mm)		
3,2 × 10	NZAN3210	5902619624286	3,3	5,0-7,0	1000	4000
3,2 × 12	NZAN3212	5902619624293	3,3	7,0-9,0	1000	4000
4,0 × 8	NZAN4008	5902619624309	4,1	3,0-5,0	1000	4000
4,0 × 10	NZAN4010	5902619602481	4,1	4,0-6,5	1000	4000
4,0 × 12	NZAN4012	5902619624316	4,1	6,0-8,5	1000	4000
4,0 × 16	NZAN4016	5902619627560	4,1	8-12,5	500	4000
4,8 × 12	NZAN4812	5902619602498	4,9	6,0-8,0	500	4000
4,8 × 16	NZAN4816	5902619627690	4,9	8-12,0	500	4000

## NITY ZRYWALNE STALOWE

nit stalowy, trzpień stalowy



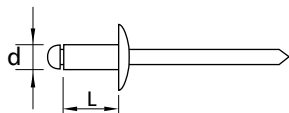

### STEEL-STEEL BLIND RIVETS

steel body, steel mandrel

#### BLINDNIETEN FLACHRUNDKOPF, STAHL/STAHL



#### TYPE: NZSS

d × L (mm)	index	EAN		 G (mm)		
3,0 × 10	NZSS3010	5902619601959	3,1	5,0-7,0	1000	4000
3,2 × 6	NZSS3206	5902619601928	3,3	1,0-3,5	1000	4000
3,2 × 8	NZSS3208	5902619601935	3,3	3,5-5,0	1000	4000
3,2 × 10	NZSS3210	5902619601911	3,3	5,0-7,0	1000	4000
3,2 × 12	NZSS3212	5902619601942	3,3	7,0-9,0	1000	4000
4,0 × 8	NZSS4008	5902619601966	4,1	3,5-5,0	1000	4000
4,0 × 10	NZSS4010	5902619601973	4,1	4,0-6,5	500	4000
4,0 × 12	NZSS4012	5902619601980	4,1	6,0-8,5	500	4000
4,0 × 14	NZSS4014	5902619601997	4,1	7,0-10,5	500	4000
4,0 × 16	NZSS4016	5902619601904	4,1	8,0-12,5	500	4000
4,8 × 8	NZSS4808	5902619615000	4,9	2,5-4,0	500	4000
4,8 × 10	NZSS4810	5902619615017	4,9	4,0-6,0	500	4000
4,8 × 12	NZSS4812	5902619615024	4,9	6,0-8,0	500	4000
4,8 × 16	NZSS4816	5902619615031	4,9	9,0-12,0	500	4000
4,8 × 20	NZSS4820	5902619615048	4,9	12,0-16,0	250	2000

## NITY ZRYWALNE NIERDZEWNE

nit nierdzewny, trzpień nierdzewny



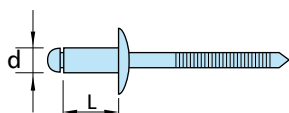

### STAINLESS STEEL BLIND RIVETS

stainless steel body, stainless steel mandrel

#### BLINDNIETEN FLACHRUNDKOPF, EDELSTAHL/EDELSTAHL



#### TYPE: NZNN

d × L (mm)	index	EAN		 G (mm)		
3,2 × 8	NZNN3208	5902619615512	3,3	3,5-5,0	1000	4000
3,2 × 10	NZNN3210	5902619615499	3,3	5,0-7,0	1000	4000
4,0 × 8	NZNN4008	5902619615505	4,1	3,0-5,0	1000	4000
4,0 × 10	NZNN4010	5902619615376	4,1	4,0-6,5	500	4000
4,0 × 12	NZNN4012	5902619615383	4,1	6,0-8,5	500	4000
4,0 × 14	NZNN4014	5902619615390	4,1	7,0-10,5	500	4000
4,0 × 16	NZNN4016	5902619615406	4,1	8,0-12,5	500	4000
4,8 × 10	NZNN4810	5902619615413	4,9	4,0-6,0	500	4000
4,8 × 12	NZNN4812	5902619615420	4,9	6,0-8,0	500	4000
4,8 × 14	NZNN4814	5902619615437	4,9	8,0-10,0	500	4000
4,8 × 16	NZNN4816	5902619615444	4,9	9,0-12,0	500	4000
4,8 × 18	NZNN4818	5902619607975	4,9	10,0-14,0	500	4000

### NITY SZCZELNE ALUMINIOWO-STALOWE

nit aluminiowy, trzpień stalowy

### CLOSED END ALUMINUM-STEEL BLIND RIVETS

alu body, steel mandrel

### DICHTNIETEN FLACHRUNDKOPF, ALU/STAHL

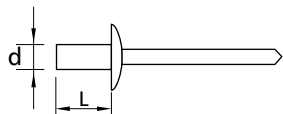

#### TYPE: NSAS

d × L (mm)	index	EAN	G (mm)		
4,0 × 8	NSAS4008	5902619601027	0,5-3,5	1000	4000
4,0 × 10	NSAS4010	5902619601201	3,5-5,0	1000	4000
4,0 × 12	NSAS4012	5902619601256	5,0-6,5	1000	4000
4,8 × 8	NSAS4808	5902619601218	1,0-3,0	500	4000
4,8 × 10	NSAS4810	5902619601034	3,5-5,0	500	4000
4,8 × 11	NSAS4811	5902619601225	5,0-6,5	500	4000
4,8 × 14	NSAS4814	5902619601232	8,0-9,5	500	4000
4,8 × 16	NSAS4816	5902619615369	9,5-11,0	500	4000

### NITY SZCZELNE ALUMINIOWO-NIERDZEWNE

nit aluminiowy, trzpień nierdzewny

### CLOSED END ALUMINUM-STAINLESS STEEL BLIND RIVETS

alu body, stainless steel mandrel

### DICHTNIETEN FLACHRUNDKOPF, ALU/ EDELSTAHL

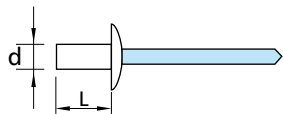

#### TYPE: NSAN

d × L (mm)	index	EAN	G (mm)		
4,0 × 9,5	NSAN4095	5902619600211	3,5-5,0	1000	4000
4,8 × 9,5	NSAN4895	5902619600228	3,0-5,0	500	1000

### NITY SZCZELNE STALOWE

nit stalowy, trzpień stalowy

### CLOSED END STEEL-STEEL BLIND RIVETS

steel body, steel mandrel

### DICHTNIETEN FLACHRUNDKOPF, STAHL/STAHL

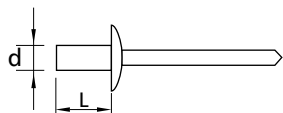

#### TYPE: NSSS

d × L (mm)	index	EAN	G (mm)		
3,2 × 8	NSSS3208	5902619615185	1,5-3,0	1000	4000
3,2 × 10	NSSS3210	5902619615208	3,0-5,0	1000	4000
3,2 × 12	NSSS3212	5902619615192	5,0-6,5	1000	4000
4,0 × 8	NSSS4008	5902619615215	1,5-3,0	1000	4000
4,0 × 10	NSSS4010	5902619615222	3,0-5,0	1000	4000
4,8 × 11	NSSS4811	5902619615178	4,0-5,5	500	4000
4,8 × 16	NSSS4816	5902619615785	7,5-10,5	500	4000

### NITY SZCZELNE NIERDZEWNE

nit nierdzewny, trzpień nierdzewny

### CLOSED END STAINLESS STEEL BLIND RIVETS

stainless steel body, stainless steel mandrel



### DICHTNIETEN FLACHRUNDKOPF, EDELSTAHL/EDELSTAHL

INOX

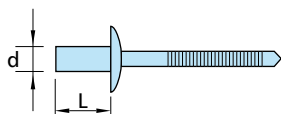
CORAL



TYPE: NSNN

d × L (mm)	index	EAN	 G (mm)		
3,2 × 10	NSNN3210	5902619601287	3,0-5,0	1000	4000
3,2 × 12	NSNN3212	5902619601485	5,0-6,5	1000	4000
4,0 × 8	NSNN4008	5902619601263	1,5-3,0	1000	4000
4,0 × 10	NSNN4010	5902619601270	3,5-5,0	1000	4000
4,8 × 11	NSNN4811	5902619601294	4,0-7,0	500	4000
4,8 × 16	NSNN4816	5902619615451	6,5-9,0	500	4000

### NITY ROZWIDLONE

nit aluminiowy, trzpień stalowy

### BLIND RIVETS PEEL TYPE



alu body, steel mandrel

### SPREIZ - BLINDNIETEN, ALU/STAHL

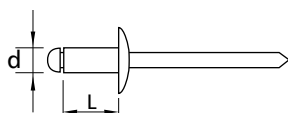
CORAL

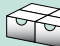

TYPE: NRAS

d × L (mm)	index	EAN		 G (mm)		
4,0 × 14	NRAS4014	5902619615338	4,1	6,0-9,0	500	4000
4,8 × 20	NRAS4820	5902619615321	5,3	10,0-14,0	500	4000
4,8 × 25	NRAS4825	5902619607999	5,3	12,0-19,0	250	2000

### NITONAKRĘTKI STALOWE

ocynkowane

### FLAT HEAD RIVET NUTS



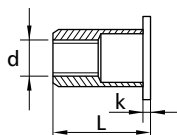

zinc plated

### BLINDNIETMUTTERN

verzinkt



TYPE: NKS

d × L (mm)	k (mm)	index	EAN		 G (mm)		
M6 × 16	1,5	NKS0616	5902619615345	9	2,3-4,0	500	4000
M8 × 18	1,5	NKS0818	5902619615352	11	0,5-3,5	250	2000

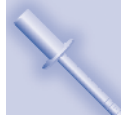

**NITOWNICA RĘCZNA PROFI**  
**PROFESSIONAL HAND RIVETER**  
**PROFI NIETZANGE**



TYPE: NRP

index	EAN	
N-48-010	5902619610272	1

**NITOWNICA DŹWIGNIOWA PROFI**  
**PROFESSIONAL LEVER HAND RIVETER**  
**PROFI HEBELNIETZANGE**



TYPE: NDP

index	EAN	
N-48-001	5902619610258	1

**NITOWNICA HARMONIJKOWA PROFI**  
**PROFESSIONAL LAZY TONG HAND RIVETER**  
**PROFI SCHERENNIETZANGE**



TYPE: NHP

index	EAN	
N-48-002	5902619610265	1